

WATERPROOF NON MAINTAINED / MAINTAINED EMERGENCY LUMINAIRES WITH WHITE LEDs



TECHNICAL CHARACTERISTICS (for LED MODULE Specs see page 4)

	GR-1935/15L	GR-1935/30L	GR-1936/15L	GR-1936/30L
OPERATION VOLTAGE	220-240V AC/50-60Hz			
MAXIMUM POWER CONSUMPTION	3.1W/3.3VA	3.3W/3.5VA	3.4W/3.6VA	4.5W/4.8VA
BATTERIES (Ni-Cd)	3.6V/0.6Ah	3.6V/1.5Ah		3.6V/3Ah
BATTERY PROTECTION	From overcharge and deep discharge			
INDICATIONS	Charge indication LED			
CHARGING TIME	24h			
MINIMUM AUTONOMOUS DURATION	90min		180min	
ILLUMINATION SOURCE	15 white LEDs	30 white LEDs	15 white LEDs	30 white LEDs
ILLUMINATION (MAINS / EMERGENCY)	40lm / 105lm	40lm / 210lm	40lm / 105lm	40lm / 210lm
DEGREES OF COVER PROTECTION	IP65			
PRODUCED IN ACCORDANCE WITH	EN 60598-1, EN 60598-2-22, EN 55015, EN 61547, EN 61000-3-2, EN 61000-3-3			
OPERATION TEMPERATURE RANGE	5 to 40 °C			
RELATIVE HUMIDITY	Up to 95%			
CONSTRUCTION MATERIALS	Bayblend FR3010, transparent polycarbonate			
EXTERNAL DIMENSIONS	313 x 118 x 66 mm			
TYPICAL WEIGHT	630gr.	710gr.		810gr.
GUARANTEE	3 years (1 year for the battery)			

**Thank you for your trust in our products.
Olympia Electronics - European manufacturer.**

GENERAL

These luminaires are used where emergency light is needed. Each luminaire must be permanently connected to the mains power supply. In normal operation the battery is charging, the green LED and 2 yellow LED's light in non-maintained operation. The green LED and the LED strip light in maintained operation. In case of a mains power supply failure the luminaire will light the LED strip automatically in emergency mode. When the mains power supply is restored the device turns to normal operation.

Non maintained / maintained operation

There is an option to select the non-maintained or maintained operation by placing the jumper to the appropriate place (page 2).

INSTALLATION

To install the luminaire follow the installation instructions on page 2.

ATTENTION!!!

1. Operations for installation, maintenance

or testing must be done by authorized personnel only.

2. The luminaire must be connected to the mains power supply through a fuse dependent on the total amount of the line's power load.

3. It is suggested to check every month the indication LED for battery charging, and by placing the test card (A-1900) (page 3) an operation test is initiated, to check the emergency circuit. The illumination source should light as long as the card is present. In the opposite condition contact the installer.

4. It is suggested to check every 6 months the minimum autonomous duration by disconnecting the mains power supply. Count the time that the led strip lights and in case of less time than the minimum autonomous duration the battery must be replaced. If the measured time is considerably less than the minimum autonomous duration contact the installer. In case of battery or led strip replacement,

these must be replaced by parts of the same type, by the manufacturer or by a competent person.

5. In case of inactive use for a period greater than 2 months, disconnect the battery by pulling out the battery's connector.

6. It is not allowed to discard batteries in to common trash bins, they must be discarded only in battery recycling points. Do not incinerate.



NOTE: LED= Light Emitting Diode

LABELING EXPLANATION:

X: Self contained

1: Maintained (*)

A: Including test device

G: Internally illuminated

***90:** 1.5 hour duration

180: 3 hours duration

(*) Maintained operation: The luminaire lights its illumination source, when it is powered by the mains power supply or not.

Non Maintained operation: The luminaire lights its illumination source, only in power supply's failure.

Note!! The installer should fill in, on the specification label, the letter **G** if the luminaire is used as a safety sign.

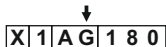

NOTE!! After finishing the installation you must power the luminaire at least for 24 hours for battery charging to perform the nominal autonomy.

Battery replacement

It can be done only by a competent person and after the mains interruption.

1. Follow the step 1 of the installation instructions and remove the diffusor.
2. Remove the reflector (step 1 of the installation instructions).
3. Remove the old battery and place a new one of the same type and characteristics.
4. Replace the removed parts (previous steps 1, 2).



The light source contained in this luminaire shall only be replaced by the manufacturer, or his agent, or a similar qualified person.

NOTE! *The light source is non-user replaceable.*

WARRANTY

Olympia Electronics guarantees the quality, condition and operation of the goods. The period of warranty is specified in the official catalogue of Olympia Electronics and also in the technical leaflet, which accompanies each product. This warranty ceases to exist if the buyer does not follow the technical instructions included in official documents given by Olympia Electronics or if the buyer modifies the goods provided or has any repairs or re-setting done by a third party, unless Olympia Electronics has fully agreed to them in writing. Products that have been damaged can be returned to the premises of our company for repair or replacement, as long as the warranty period is valid. Olympia Electronics reserves the right to repair or to replace the returned goods and to or not charge the buyer depending on the reason of defection. Olympia Electronics reserves the right to charge or not the buyer the transportation cost.

HEAD OFFICE

72nd km. O.N.R. Thessaloniki-Katerini
P.C. 60300 P.O. Box 06 Eginio Pierias Greece

www.olympia-electronics.gr

info@olympia-electronics.gr

INSTALLATION INSTRUCTIONS FOR WALL OR CEILING MOUNTING

- ① Unclip the plastic latches with a flat blade screwdriver, unfasten the 2 screws (not all the way, *step 8 B*) and remove the diffuser. Place simultaneously 2 flat blade screwdrivers to the recesses and pull up gently the reflector.
- ② Install the base plastic (with the included mounting screws and plugs). **WARNING!! To preserve the IP65 rating, fit the screws with the metallic washers and plastic rings which are included.**
- ③ Always use in any case round mains cable, with external diameter of 5-10mm (H05RN-F type 2x1mm² or any other type, at least equal to it's mechanical and electrical properties).
ATTENTION!! The cable must not be deformed in any way (This requirement is important to ensure the IP65 rating). Install the gasket and make a hole in the center by using a small screwdriver. Pass the round cable through the gasket. Install the second included gasket in to the unused hole.
- ④ Place the battery's connector to the corresponding connector on the P.C.B.
- ⑤ Connect the mains cables to the respective terminal block **N** for neutral, **L** for live wire.
- ⑥ Install the included tie to fasten securely the power cables.
- ⑦ Refit the reflector (mind the holes of the indications).
- ⑧ Finally place the diffuser (mind the holes of the indications). **Attention!! First the plastic latches (A) must be secured (click sound) and then fasten the 2 screws (B) (tightening torque 1.2 Nm).**

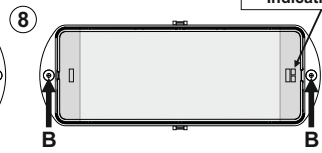
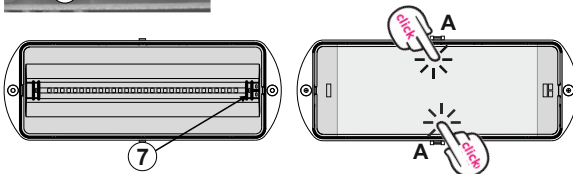
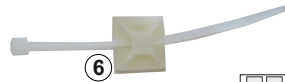
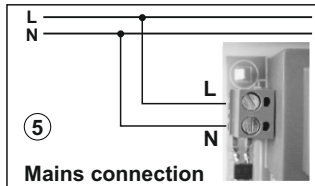
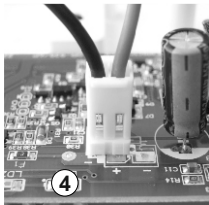
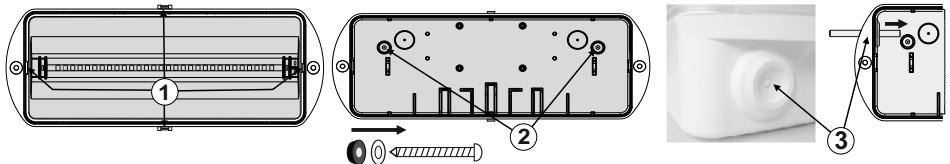

NON MAINTAINED/MAINTAINED OPERATION JUMPER SELECTION

You can choose the luminaire's operation. When the jumper is installed (by default) in the middle and left pins *maintained operation is selected*.

When the jumper is installed in the middle and right pins *non-maintained operation is selected*.

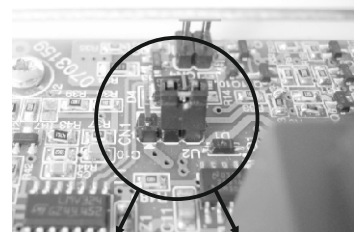

 Maintained operation

 Non Maintained operation

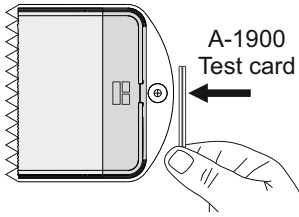

Manual TEST with the A-1900 Test card (not included). This card is available only after request. In order to test the device, you must place the card on the side of the indications. This operation lasts as long as the card is present.

LED MODULE CHARACTERISTICS

	GR-1935/15L	GR-1936/15L	GR-1935/30L	GR-1936/30L
Manufacturer	Olympia Electronics S.A.			
Model Number	2502159/15L		2502159/30L	
Voltage Range	2.9-3.6 V DC			
Nominal Power	980mw		1960mw	
Connections	Non reversible connection between main pcb and led module			
Temperature (tc)	47 °C max. across the board			