



olympiaTM
electronics

SAFETY & SECURITY SYSTEMS

for a safer world!

Our history



for a safer world!

Olympia Electronics was established in **1979** by Nikolaos Lakasas and Panagiotis Arvanitidis.

It is one of the oldest and largest Electrical & Electronic manufacturers in Greece

The company employs over than **165 people**.

In **1981** Olympia Electronics entered in emergency lighting manufacturing process.

In **1985** Olympia Electronics entered in fire alarm manufacturing process.

In **1986** became the dominant firm in Greece as concerns Electronic Safety and Security industry

Our history



for a safer world!

In **1989** we are starting our export activities

During **1990** and **1999** the company expands its products (9 families) while is remaining the dominant firm in the market.

During **1999** and **2007** the company is awarded by many institutions for its successful & innovative business activities.

On February **2005** Olympia Electronics gained the EFQM (European Foundation Quality for Management) recognition

In **2014** the company inducts two new product families: emergency lighting and fire detection systems for marine applications.

Today Olympia Electronics manufactures six main product categories and export in 72 countries worldwide.

Product families



for a safer world!

Emergency Lighting

Fire Detection

Burglar Alarm

Gas Detection

Room Thermostats

Hotel Access

Electric Insect Traps



Quality



for a safer world!

We are certified for ISO 9001 by TUV, OHSAS 18001:2007 by Lloyd's Register, ISO 14000:2004 by Bureau Veritas

Our products are certified by BSI, TUV, VDS, LPCB, EVPU

We have many local approvals like ELOT, ANKO, Gost, etc.

We fulfil the European Norms i.e. EN 60598-2-22, EN 54 etc.

All our products have CE marking, DoC, Reach & RoHS.

Since 2011 the company holds the bee bronze award of the European Business Ethics Network.



Our sales network (exports)



for a safer world!

Exports in 72 countries:

- European Union (71% of our exports)
- East European countries and Russia
- Middle East & Gulf countries
- Africa
- U.S.A (just started)



Sales per family (%)



olympiaTM
electronics
SAFETY & SECURITY SYSTEMS

for a safer world!

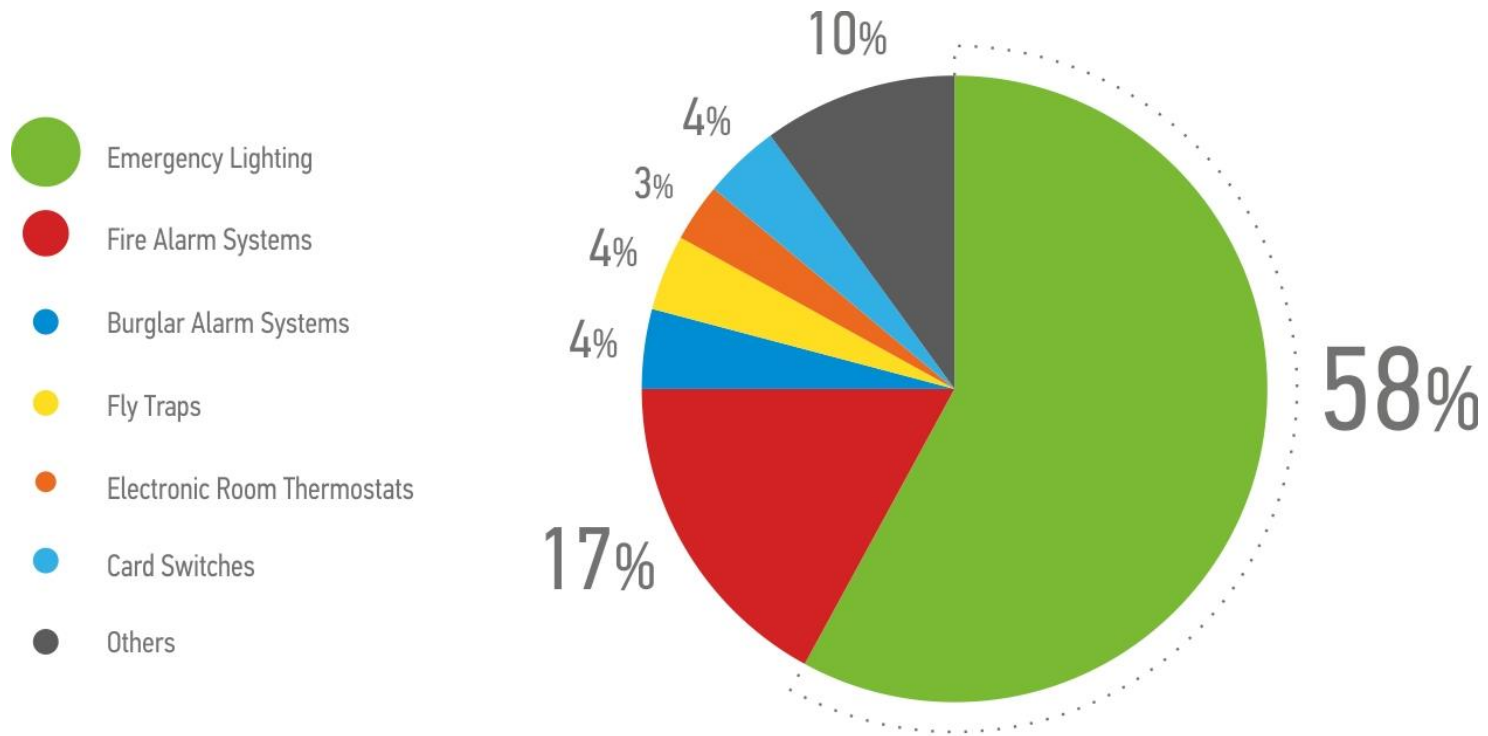



for a safer world!



Emergency Lighting

General Guides



Emergency Lighting



for a safer world!

Types of signs
according to
105/1995 standards



For example: In a corridor with a length of 20 meters we must install an indication sign with a height of at least 10cm at one end in order for it to be clearly visible in the other end.

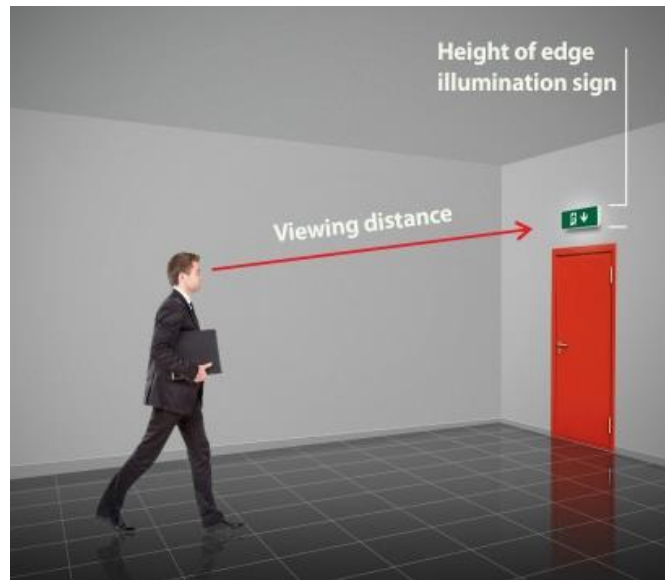



Emergency Lighting

Installation of emergency luminaires



olympiaTM
electronics
SAFETY & SECURITY SYSTEMS

for a safer world!

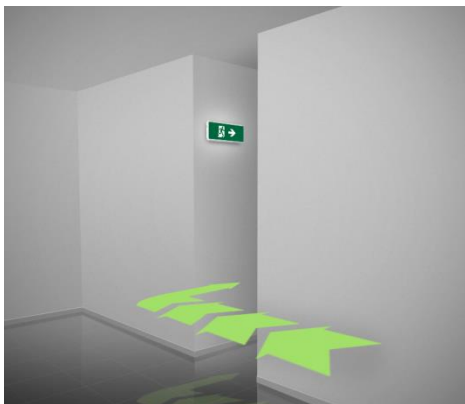

Near corridor crossings.

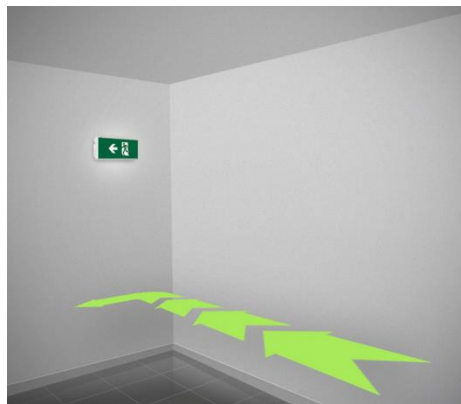

Close to corridor ending where a change of direction is required.



Near Hazard exits.

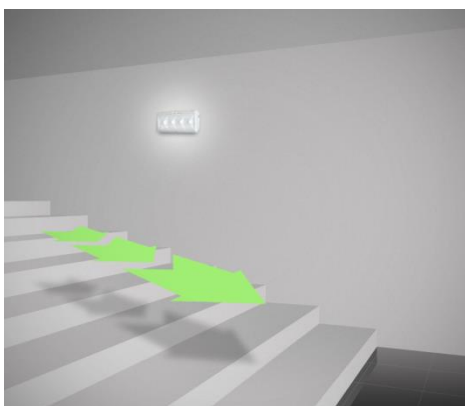

In stairwells to supply sufficient illumination to each step.

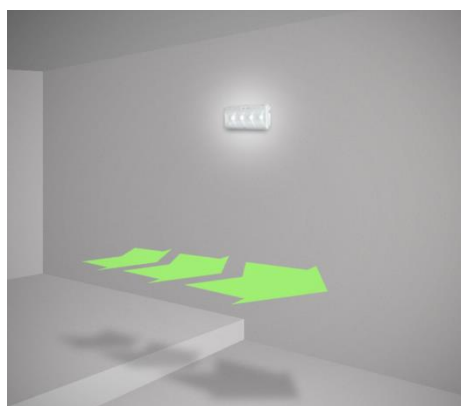

Near each floor level variation.



Emergency Lighting

Installation of emergency luminaires



for a safer world!

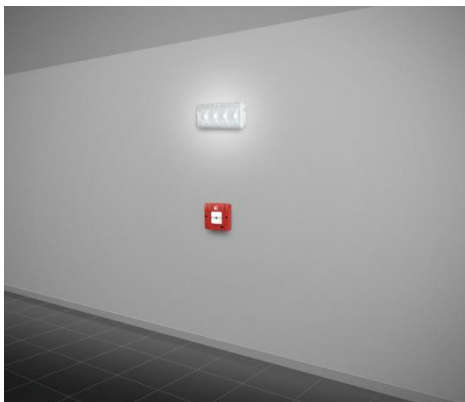

Near every call point.



Externally or near every final exit.



Near fire-extinguishing gear (e. i. Fire hoses).

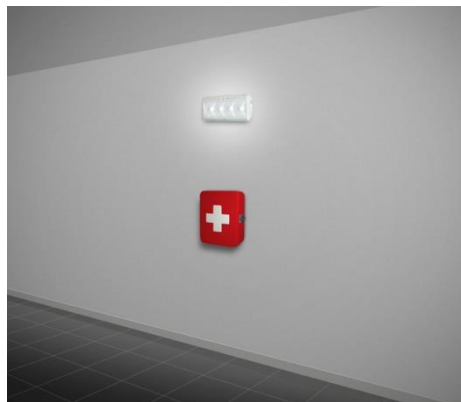

Near first aid stations.



By the term “**Near**” we mean a maximum of 2m in a horizontal direction from the mentioned point. These points must contain luminaires with suitable indication and marking legends.



Emergency Lighting

Example of installation of emergency and indication luminaires



olympiaTM
electronics
SAFETY & SECURITY SYSTEMS

for a safer world!

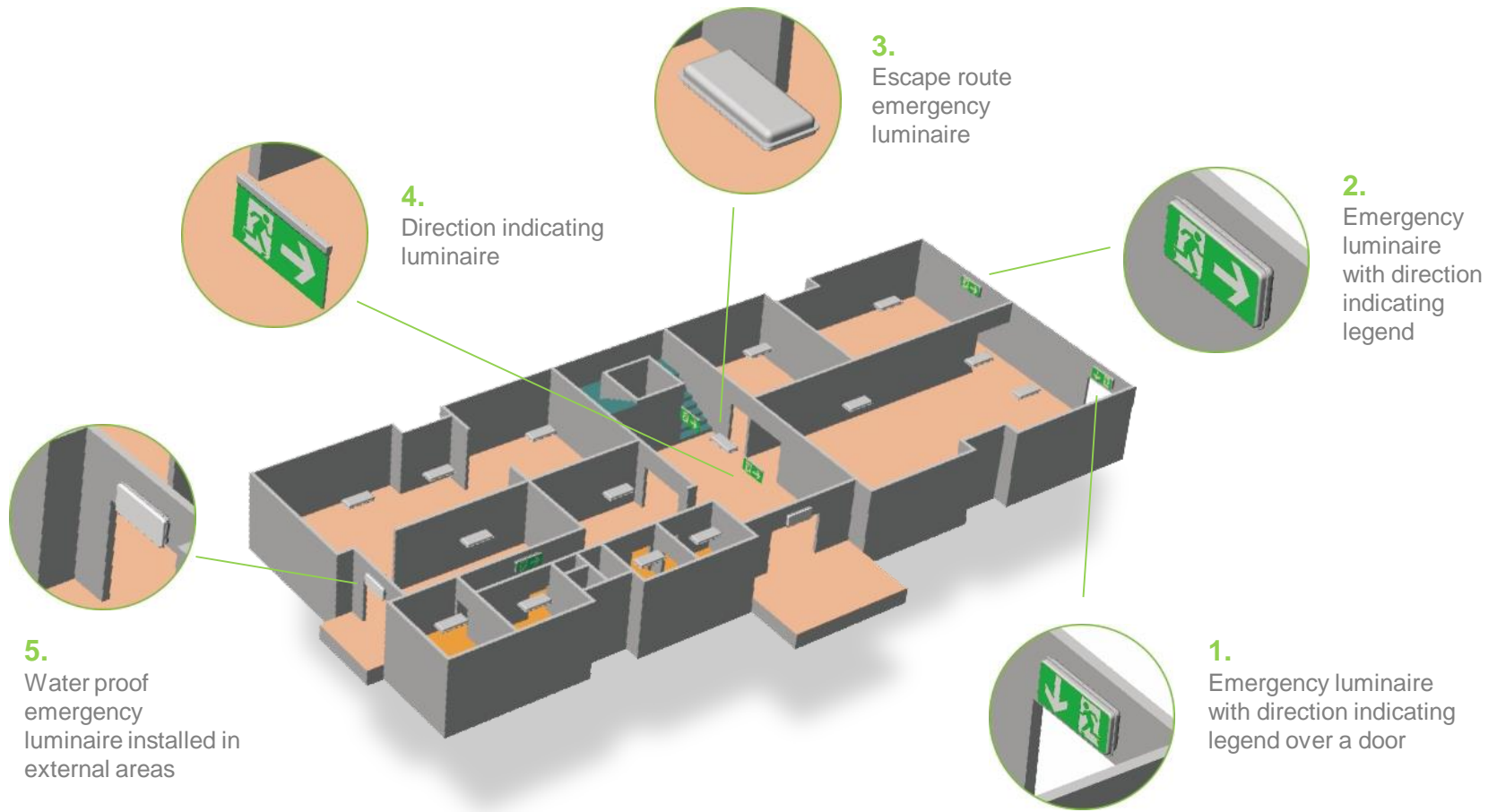



Emergency Lighting



for a safer world!

Separation according their function: The luminaries are divided into **maintained** and **non maintained**. Maintained luminaries light continuously when the mains power supply is on and when there is a mains power supply failure, Non maintained luminaries light only when there is a mains power supply failure.

Separation according their back up source: The luminaries are divided into **self contained** luminaries and **CBS luminaries**. Self contained luminaries have as back up source batteries in their housing. CBS luminaries are powered by a central battery system, they don't have batteries in their housing.

Separation according their testing: The luminaries are divided into **self-testing** luminaries, **simple luminaries** and **addressable luminaries**. Self testing luminaries have their CPU check to basic functions and have the corresponding indications. Simple luminaries need manually checking. Addressable luminaries can be monitored and checked from a main panel.



for a safer world!



Emergency Lighting

Product categories



Addressable & Net Light

Addressable luminaires control panel



olympiaTM
electronics
SAFETY & SECURITY SYSTEMS

for a safer world!



- ✓ 250 emergency luminaires
- ✓ Inhibit function for all luminaires
- ✓ 16 zones
- ✓ Capability for connecting several panels on an ethernet network
- ✓ The programming, control and testing of the system can be done using a web browser (Internet Explorer, Mozilla Firefox, Chrome)

Connection Diagram



Suitable for
Large areas
Installations, such as
malls, hotels,
hospitals, airports etc.



GR-8500 24V DC CENTRAL BATTERY SYSTEM (CBS)



for a safer world!



Dimensions in mm

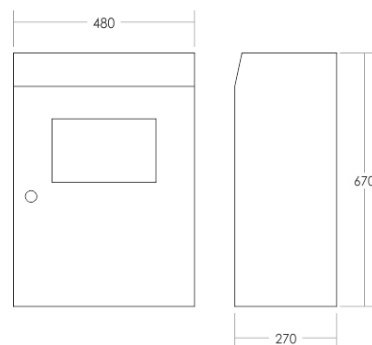

- ✓ Output: 24V DC
- ✓ 300 - 600W panels
- ✓ 4-16 zones
- ✓ Capability for connecting several panels on an ethernet network
- ✓ The programming, control and testing of the system can be done using a web browser (Internet Explorer, Mozilla Firefox, Chrome)
- ✓ Independent program for each zone for maintained or non-maintained operation.

Compatible battery type



PowerSonic PS-12350 for 24V/300W

Type	PS-12350
Battery capacity (Ah)	33
Battery voltage (V)	12

Duration

Capacity

300W

1h	300W
1,5h	250W
3h	130W
8h	50W

600W

1h	600W
1,5h	500W
3h	260W
8h	100W

75W Power capacity per zone



GR-9500 230V AC CENTRAL BATTERY SYSTEM (CBS)



for a safer world!



Dimensions in mm

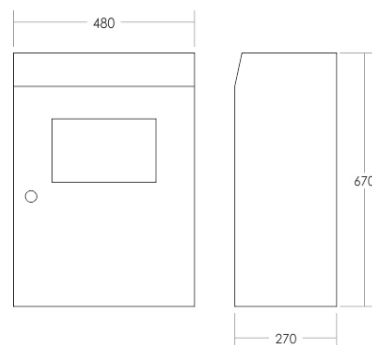

- ✓ Output: 230V AC
- ✓ 300 – 600VA panels
- ✓ 4-8 zones
- ✓ Capability for connecting several panels on an ethernet network
- ✓ The programming, control and testing of the system can be done using a web browser (Internet Explorer, Mozilla Firefox, Chrome)
- ✓ Independent program for each zone for maintained or non-maintained operation.

Compatible battery type



PowerSonic PS-12550 B for 230V/600VA

Type	PS-12350 B
Battery capacity (Ah)	55
Battery voltage (V)	12

Integrated Power Inverters



MeanWell TS-400 inverters transform the 24VDC voltage provided from the battery to 230VAC
230VAC inverter output is isolated from mains voltage connections

Duration

Capacity

300VA

1h	300VA
1,5h	250VA
3h	130VA
8h	50VA

600VA

1h	600VA
1,5h	500VA
3h	260VA
8h	100VA

75VA Power capacity per zone



CBS CONNECTION DIAGRAM



olympiaTM
electronics
SAFETY & SECURITY SYSTEMS

for a safer world!

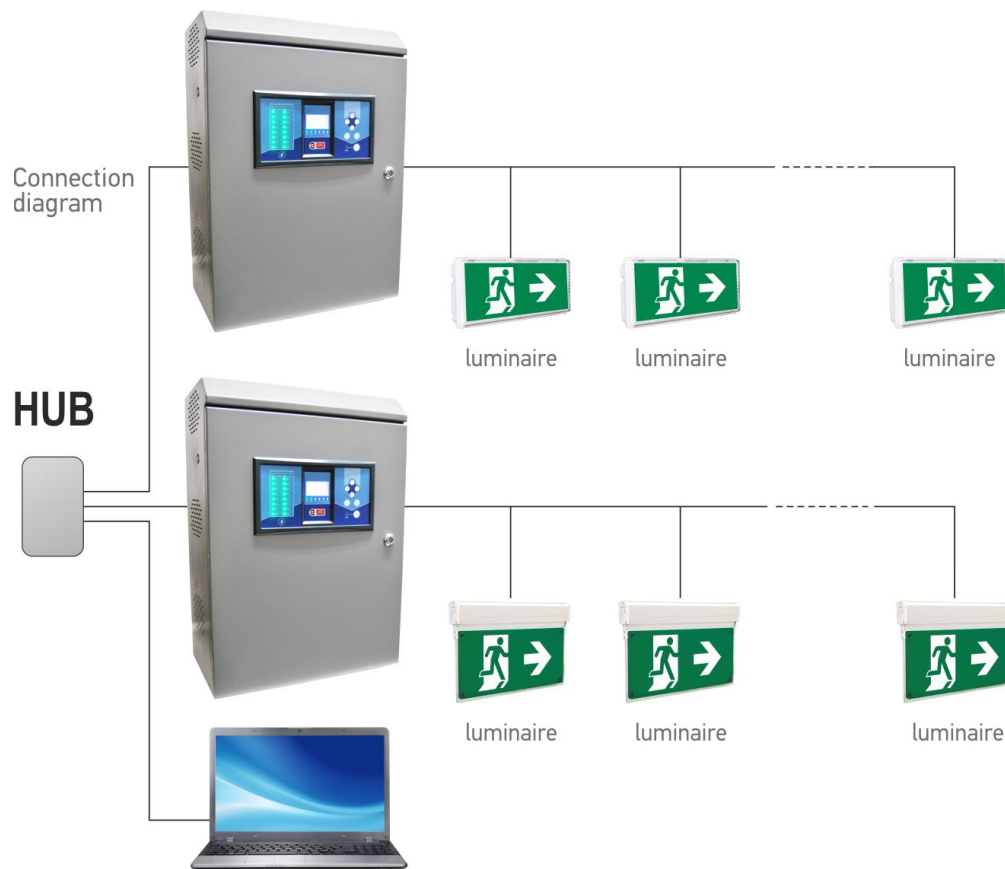



ABOUT CBS



for a safer world!

- ✓ Normal Mode Output 24VDC
- ✓ Emergency Mode Output 24VDC
- ✓ 300W or 600W Maximum Power Output
- ✓ Control and monitoring system
- ✓ Expandable number of illumination circuits (zones) up to 16
- ✓ Selectable operation mode (maintained or non-maintained) in each zone
- ✓ Battery overpower detection
- ✓ Battery overheat detection
- ✓ Zone overpower detection
- ✓ Current monitoring available in each zone (5% to 50%)
- ✓ Scheduled timer options for maintained illumination
- ✓ Inhibit Mode
- ✓ BMS connections included (relays)
- ✓ Staircase lights operation
- ✓ Control input for external mains voltage monitoring devices
- ✓ Protection against battery deep-discharge
- ✓ Programmable function and capacity test
- ✓ Remote control via Ethernet connection (optional)
- ✓ Network panels up to 32 panels
- ✓ Autonomy 1h up to 8h





CBS CONNECTIVITY



for a safer world!



- ✓ Remote control and programming via Ethernet connection using Ethernet controller card (optional) with web page interface
- ✓ Panel network via Ethernet connection (master panel – subpanels) up to 32
- ✓ USB connection for updating main board firmware





Weather light SUPER CAPACITOR



olympiaTM
electronics
SAFETY & SECURITY SYSTEMS

for a safer world!



Maintained / Self-testing



1 h



Leds, 210/80lm



7W/7,5VA



IP65



24m

Double sided diffuser

The GR-900/30L/SC can also be provided with plastic double sided diffuser with order code: GR-XXX/A-1017



A-1017



Super capacitor
technology



10 years
Guarantee

Dimensions in mm

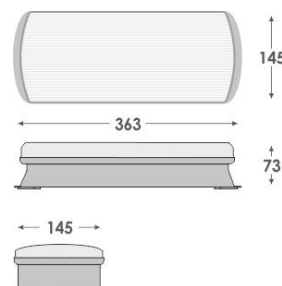

Mounting methods





Weather light SUPER CAPACITOR



for a safer world!

The GR-900/30L/SC has a power pack consisting of super capacitors and not conventional batteries

It has a total guarantee of 10 years

It is self-testing with advanced circuits for charging and discharging the capacitors

It has low consumption and a high Power Factor 0.93

100.000 hours LED lifetime

Photoluminescent sign.





Eco light PLD-25/SC



for a safer world!



Edge illumination sign / Maintained / Non-maintained (test button) / Self-testing / CBS



3 h



Leds, 100lm



2,5W – 3,2VA



IP44



25m

Dimensions in mm

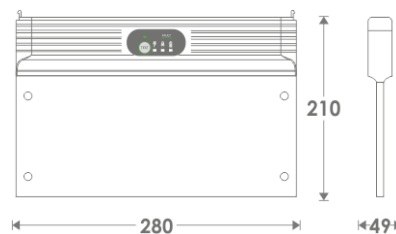

Super capacitor
technology



10 years
Guarantee





olympiaTM
electronics

SAFETY & SECURITY SYSTEMS

for a safer world!

www.olympia-electronics.gr